

Sheaves

6C/QD STYLE

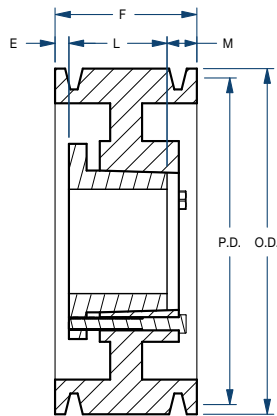

BLACKSTAR®



Type A

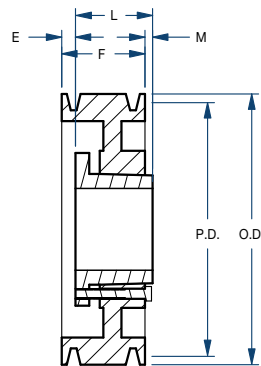

Type B

Part No.	Bushing	Bore Range (in)	Type	Diameter (in)		Dimensions (in)				Weight less Bushing (lbs)
				Pitch	Outside	E	F	L	M	
6C60SF	SF	1/2 – 2-15/16	A	6.0	6.40	1-1/32	6-1/4	2-1/16	3-5/32	20.0
6C70SF	SF	1/2 – 2-15/16	A	7.0	7.40	1-1/32	6-1/4	2-1/16	3-5/32	26.0
6C75SF	SF	1/2 – 2-15/16	A	7.5	7.90	1-1/32	6-1/4	2-1/16	3-5/32	29.0
6C80E	E	7/8 – 3-1/2	A	8.0	8.40	1-5/32	6-1/4	2-3/4	2-11/32	36.0
6C85E	E	7/8 – 3-1/2	A	8.5	8.90	1-5/32	6-1/4	2-3/4	2-11/32	39.0
6C90F	F	1 – 4	A	9.0	9.40	1-1/32	6-1/4	3-3/4	1-15/32	51.0
6C95F	F	1 – 4	A	9.5	9.90	1-1/32	6-1/4	3-3/4	1-15/32	55.0
6C100F	F	1 – 4	A	10.0	10.40	1-1/32	6-1/4	3-3/4	1-15/32	59.0
6C105F	F	1 – 4	A	10.5	10.90	1-1/32	6-1/4	3-3/4	1-15/32	62.0
6C110F	F	1 – 4	A	11.0	11.40	1-1/32	6-1/4	3-3/4	1-15/32	66.0
6C120F	F	1 – 4	A	12.0	12.40	1-1/32	6-1/4	3-3/4	1-15/32	70.0
6C130F	F	1 – 4	A	13.0	13.40	1-1/32	6-1/4	3-3/4	1-15/32	74.0
6C140F	F	1 – 4	A	14.0	14.40	1-1/32	6-1/4	3-3/4	1-15/32	80.0
6C160F	F	1 – 4	A	16.0	16.40	1-1/32	6-1/4	3-3/4	1-15/32	89.0
6C180F	F	1 – 4	A	18.0	18.40	1-1/32	6-1/4	3-3/4	1-15/32	102.0
6C200F	F	1 – 4	A	20.0	20.40	17/32	6-1/4	3-3/4	1-31/32	112.0
6C240F	F	1 – 4	A	24.0	24.40	17/32	6-1/4	3-3/4	1-31/32	131.0
6C270J	J	1-1/2 – 4-1/2	A	27.0	27.40	1/16	6-1/4	4-5/8	1-9/16	160.0
6C300J	J	1-1/2 – 4-1/2	A	30.0	30.40	1/16	6-1/4	4-5/8	1-9/16	190.0
6C360J	J	1-1/2 – 4-1/2	A	36.0	36.40	1/16	6-1/4	4-5/8	1-9/16	232.0
6C440J	J	1-1/2 – 4-1/2	A	44.0	44.40	1/16	6-1/4	4-5/8	1-9/16	299.0
6C500M	M	2 – 5-1/2	B	50.0	50.40	7/32	6-1/4	6-3/4	23/32	320.0